

Product Overview

The ALAMLB is an articulating ballhead tilt and swivel arm mount that collapses to a slim 3.25"/8.2CM yet extends a full 20"/50CM while offering 180° swivel and ±15° tilt. It also allows for 360° Rotation adjustment for landscape and portrait viewing and also to ensure a level display. The ALAMLB supports 75-400mm VESA hole patterns. Most 23-55"/58CM-139CM LCD displays use a VESA (Video Electronic Standards Association) hole pattern in this range. The mount will fit most 23-49" TVs, some TV's larger up to 55"/139CM will need the extension brackets. The arms and mounting brackets are constructed with 100% High Grade Steel for a sturdy and reliable mount. The ALAMLB comes with a complete hardware kit for mounting to the wall and to the back of your TV. Additionally, this mount can be used to install your TV up on the ceiling as shown in this manual.

Key Features:

- Fits VESA Hole Patterns 75-400MM
- Flush 3.25"/8.2CM Profile When Folded Yet Extends to a Full 20"/50CM
- 180° Swivel, ±15° Tilt
- 360° Rotation Adjustment
- Made from High Grade Steel
- Single Stud Installation
- Ceiling Mounting Installation Option
- Installation Hardware Included

Specifications:

Model: ALAMLB
Supported VESA Hole Patterns:
75x75mm (3x3"/1.3x1.3CM)
100x100mm (4x4"/1.8x1.8CM)
100x200mm (4x8"/1.8x3.6CM)
200x200mm (8x8"/3.6x3.6CM)
200x400mm (8x15.75"/3.6x7.1CM)
300x400mm (11.8x15.75"/5.3x7.1CM)
400x400mm (15.75"x15.75"/7.1x7.1CM)
Unit Weight: Net: 4.15LBS/1.8KG
Gross: 6LBS/2.7KG
Unit Materials: Arms, Wall Plate and TV Plate: 100% High Grade Steel
Tilt Range: ±15°
Swivel Range: Up to 180°
Rotation Adjustment: 360°
Collapsed Depth: 3.25"/8.2CM
Maximum Extension: 20"/50CM
Wall Plate Dimensions: 8.2"H x 2.9"W/20CMx7.3CM

Page 1

Step 3
Installing the TV to the TV Brackets
A Place your TV upright against a wall or couch so you can see the back. You may want to put a blanket or something to protect your screen in front.

B Locate the 4 mounting points on the back of the TV, these should be in a Square or rectangle pattern.
Sometimes the base is connected to these holes
Sometimes there are plastic covers over the holes

C There are 2 Options
Option A: Check to see if the Screws that hold the Base on are the same size as the Wall mount points, If so use those screws, if not see if the TV came with manufacturer recommended wall mount hardware, if it did use that.

Option B: We provide the most common size bolts and spacers to compensate for Length.
Open the Bag Labeled TV hardware.
If the Screw does not screw in all the way do not force it. This will cause damage to your TV. You can use a Spacer that we provide this will secure the TV by adding width.
You can install a spacer either behind the TV Plate to keep a low profile. Or you can install between the TV and TV Plate to get a little more space between the TV and the Wall.
D Once TV is installed to the Brackets, Run your Cables.

F Pair the TV plate to the mount. You will need to remove the wing nut and washers.
You can insert the TV easily by using our lift and lock design.
Insert the Bolt in the Block at the TV plate connected to the ball
Insert bolt into the arm, the weight of the TV and the Tolerance of the hole will hold it in place.
Insert the Nylon washer, metal washer, then the lock washer, and then tighten the wing nut.

E Adjust the 3 13mm nuts on the back of the Grey Ball. This is what adjusts the tension on the ball and allows the mount to lock the TVs orientation. After adjusting the tension, the wrench is designed with a magnet and may be attached to the mount for future use and safe keeping.

Page 2

Page 5

Parts List:

Part	Description	Quantity
A	M8 50mm Lag Bolts	3
B	Concrete Wall Anchors	3
C	8mm Lag Bolt Washers	3
D	M4 12mm Metric Screw	4
E	M5 16mm Metric Screw	4
F	M6 20mm Metric Screw	4
G	M8 25mm Metric Screw	4
H	3mm Plastic Spacer	4
I	5mm Plastic Spacer	4
J	5mm, 8mm Mount Washers	4ea
K	ALAMLB Mount	1
L	Extension Brackets	4
M	M5 8mm Extension Bracket Screw and nut	4
N	M8 8mm Extension Bracket Screw and nut	4
O	Wrench	1

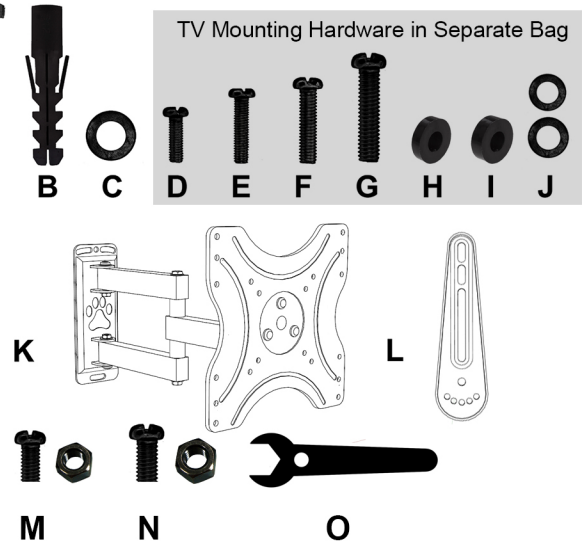

Page 2

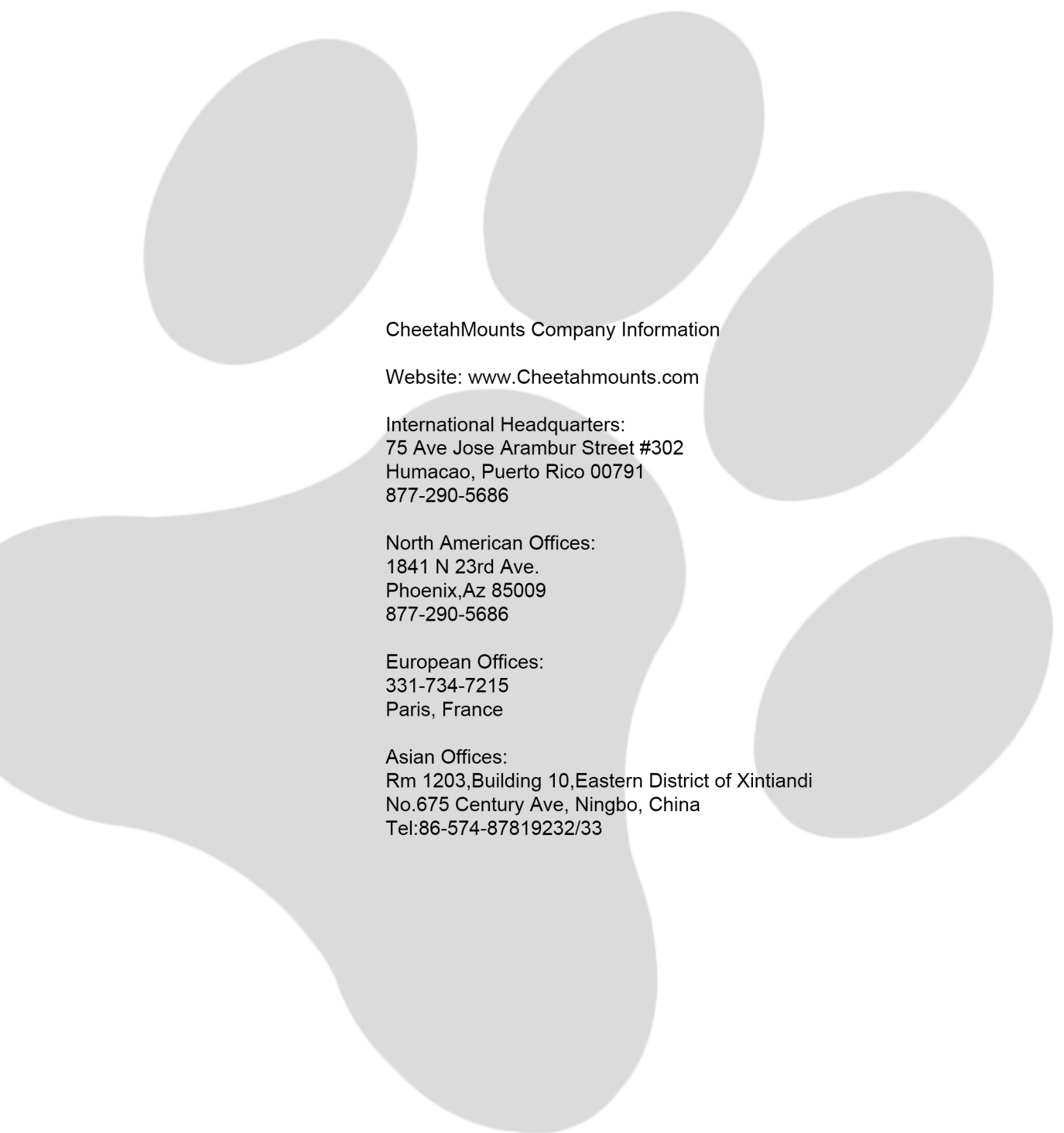

CheetahMounts Company Information

Website: www.Cheetahmounts.com

International Headquarters:
75 Ave Jose Arambur Street #302
Humacao, Puerto Rico 00791
877-290-5686

North American Offices:
1841 N 23rd Ave.
Phoenix,Az 85009
877-290-5686

European Offices:
331-734-7215
Paris, France

Asian Offices:
Rm 1203,Building 10,Eastern District of Xintiandi
No.675 Century Ave, Ningbo, China
Tel:86-574-87819232/33

Decision Table
During Assembly you will have different options for the following: Please be carefule to follow the correct option for you.
Step 1: Assembly
Option A For TV's with VESA 200 or smaller hole patterns
Option B For TV's with VESA patterns over 200
Step 2: Installation
Option A For Drywall installation
Option B For Masonry installation
Option C Ceiling Mount
TV Mounting
Option A Hardware from your TV base on or included from manufacturer
Option B Use our Hardware

Step 1
This mount has 2 configurations depending on your TV's Hole Pattern.

Option A
If you are installing a TV with a VESA 200x200 hole pattern (8"x8") or smaller.
A. The Mount Comes in the Box in Several Pieces You will need the Arm and wall section that come assembled, as well as the TV Plate. This is the roughly 8" plate with a Grey ball in the center, there is a metal block with behind the plate.
B. You can disregard the Wing Pieces you will not need these for the VESA 200x200 (8"x8") and smaller TVs.

Option B
If you are installing a TV with a Hole Pattern larger than 200x200 (8"x8")
A. Open up all the pieces of the mount, You will need the Wall Plate / Arm later but for now get the TV Plate. This is a roughly 8" piece of metal with a grey ball in the center.
B. You will then need to open the Hardware Bag and find the 4 Short 8mm fine thread bolts and nuts. There are also 4 smaller 5mm bolts and nuts. These hold the wings on to the TV plate.
C. The wing pieces that extend the hole pattern out to 400mm are symmetrical so it does not matter where you put each wing, this is done to make installation easier.
You want to mount the Wing to the front of the TV plate. The plate will be installed by putting the flat side of the wing against the TV plate and lining up the 8mm hole in the wing to the 8mm home in the corner of the TV plate. Once you have screwed in the 8mm bolt and nut. You can install the 5mm in the second hole in the wing to TV Plate.
D. Once you have installed the wings you will want to make sure they are snug but you can still move them. When we get to installing the TV Plate to TV you may need to be able to move the wing pieces slightly to make it align.

Page 3

Step 2
Installing the Mount to Wall or Ceiling
There are 3 different options for installing this mount to the Wall or ceiling
Each option is outlined below.

Option A: Drywall Installation
A Use A Stud Finder (this will help you locate your wall studs
Use a Magnetic Stud Finder (this looks for the screws used to hang your drywall, you may need to spend some time searching but once the magnet sticks to a screw you will know there is a stud running vertical on the wall at that point)
Tap on the wall. Stud Walls are Hollow, so when you tap there will be a different sound when you hit a stud. Once you think you have found a stud we recommend taking a needle or pin and trying to stick it into the drywall.

Most drywall is 1/2 to 3/4" thick so if you can stick the pin in all the way you have not found a stud. You should keep looking ,you want to hit the stud center so if you find a stud make several holes till you find the 2 sides and then mark the center.
B Take the Wall Plate and hold it up to the height you want, with a level then mark the Center Hole in the Top of the Wall plate and the center of the slot in the bottom of the wall plate

C Use a 3/16" Drill Bit to Pre Drill the mounting holes for your Lag Bolts.

Once both holes are pre drilled hold up your wall plate and install the 2 lag bolts into the wall plate.
Tighten down with a 13mm Wrench or socket and Ratchet.
If you are using a drill make sure to not over Torque the bolt or the head may snap. We recommend snugging the lag bolts by hand.

Option B: Installing in Masonry
A Take the assembled wall plate and a Level and hold to the wall once you have the wall plate level mark the your spots for installation.
B Pre Drill using a masonry 3/8" bit at the spots you just marked
Be careful to keep the drill straight, most drills have a level do you best to make sure the hole is level and not oblonged.
C Insert the Plastic Anchors into the holes you just drilled
D Hold the mount up and install the Lag bolts with washers into the anchors to secure the mount to the wall.

Option C: Ceiling Mount Option
A Locate the studs above the ceiling.
B Use the Wall plate as a Template to mark where you will drill the holes for the mount on the ceiling.
C Tighten down the wall plate to dual arm joint, as well as the 2 arm to single arm joint so they do not move easily.
D Use a 3/16" Drill Bit to Pre Drill the mounting holes for your Lag Bolts.
Once both holes are pre drilled hold up your wall plate and install the 2 lag bolts into the wall plate. Tighten down with a 13mm Wrench or socket and Ratchet.
If you are using a drill make sure to not to over Torque the bolt or the head may snap. We recommend snugging the lag bolts by hand.

Page 4

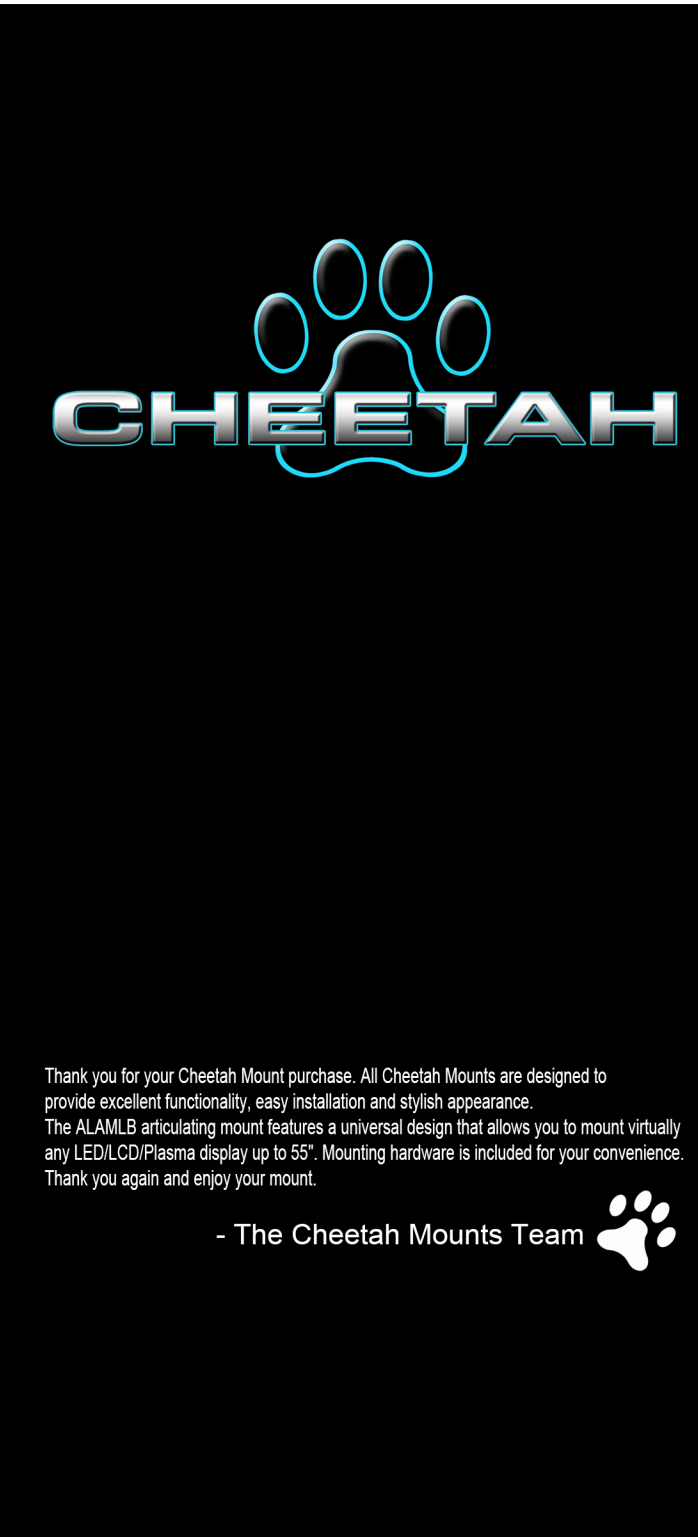

Thank you for your Cheetah Mount purchase. All Cheetah Mounts are designed to provide excellent functionality, easy installation and stylish appearance.
The ALAMLB articulating mount features a universal design that allows you to mount virtually any LED/LCD/Plasma display up to 55". Mounting hardware is included for your convenience.
Thank you again and enjoy your mount.

- The Cheetah Mounts Team



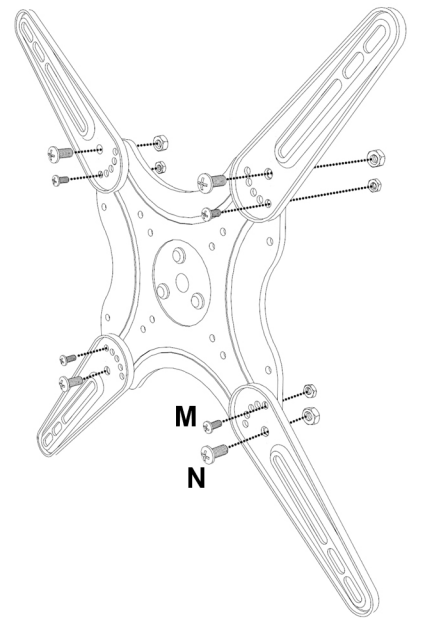
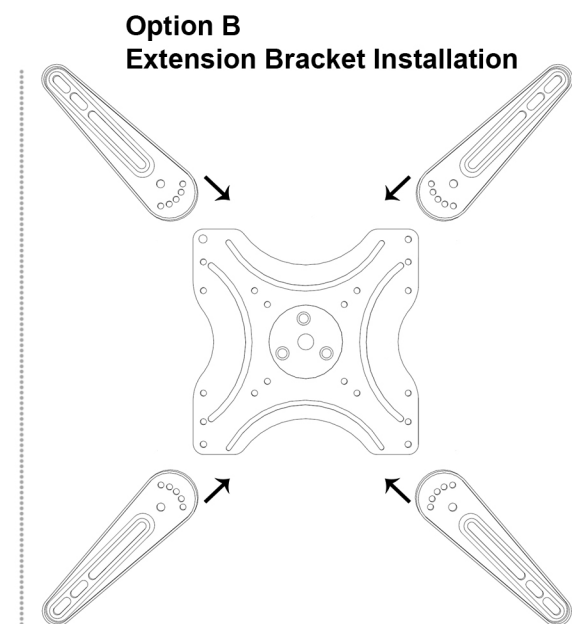
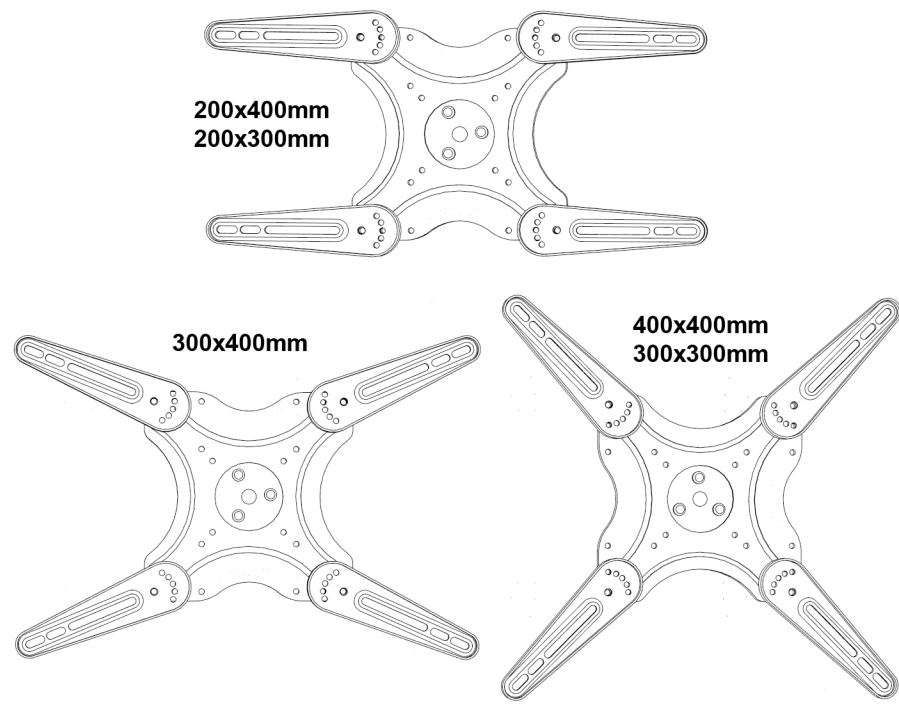
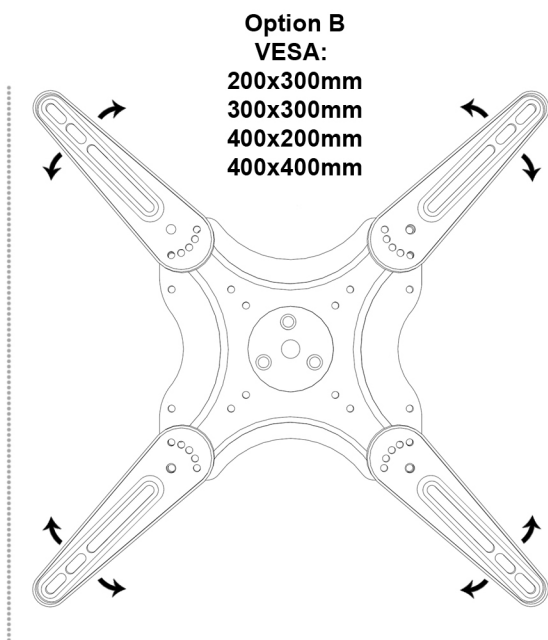
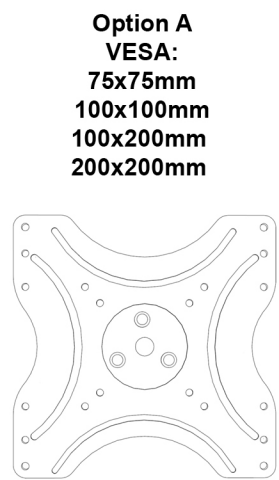

Stud/Drywall Installation:
Mark Hole Locations

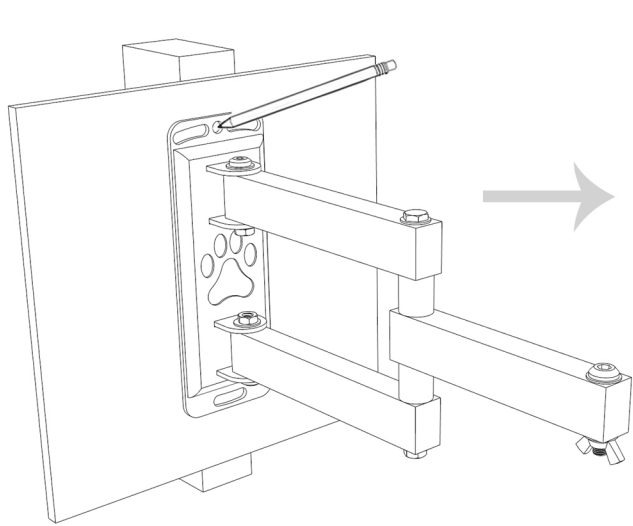

Drill Holes

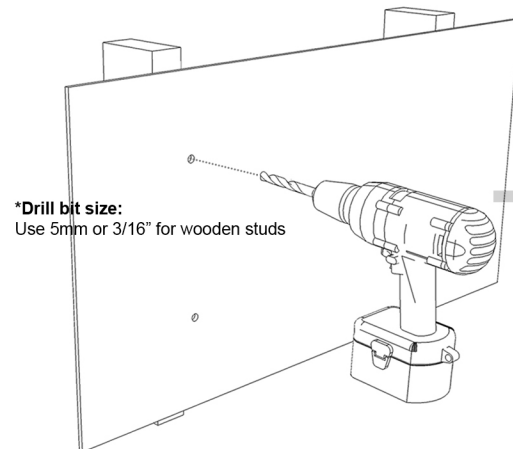

Secure Wall Plate

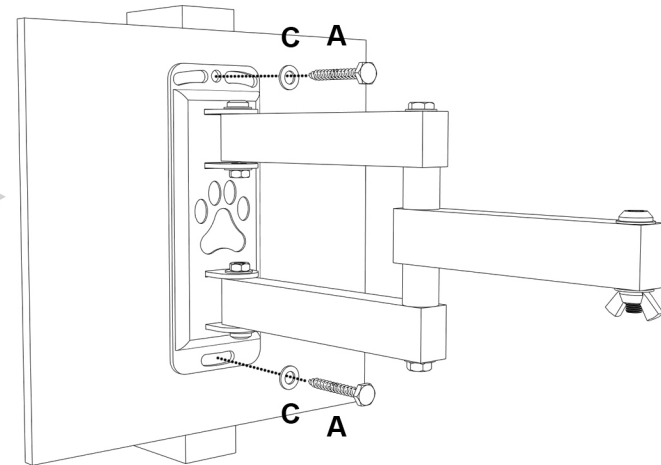

Masonry Installation:
Mark Hole Locations

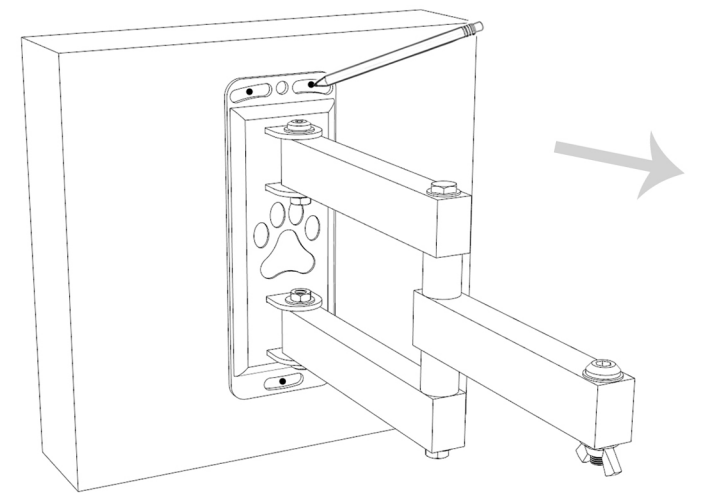

Masonry continued:
Drill Holes

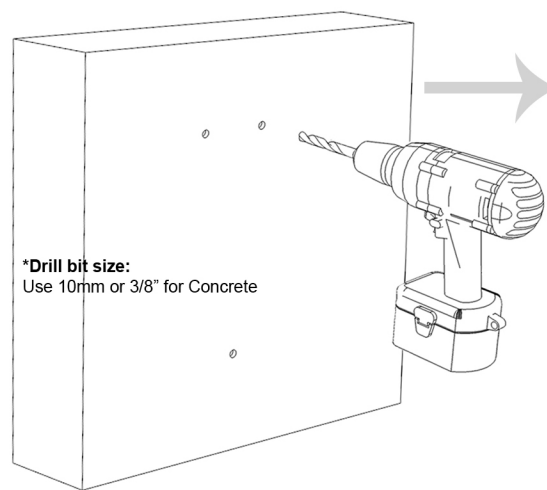

Secure Wall Plate

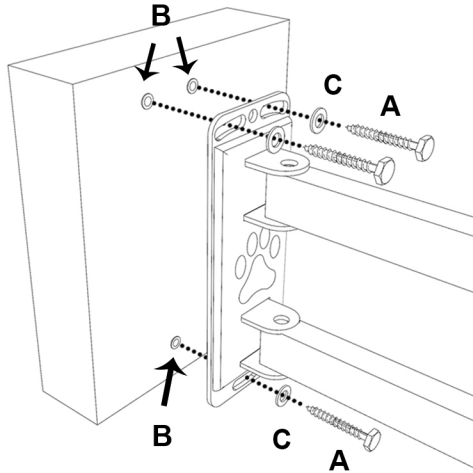

Ceiling Installation:
Mark Hole Locations

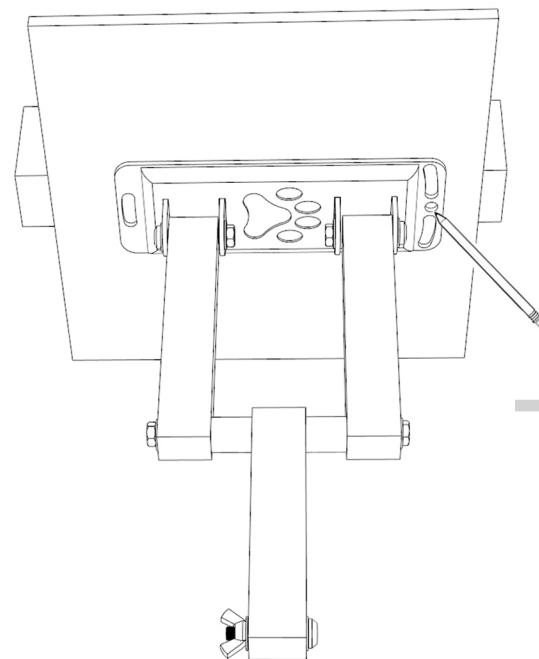

Drill Holes

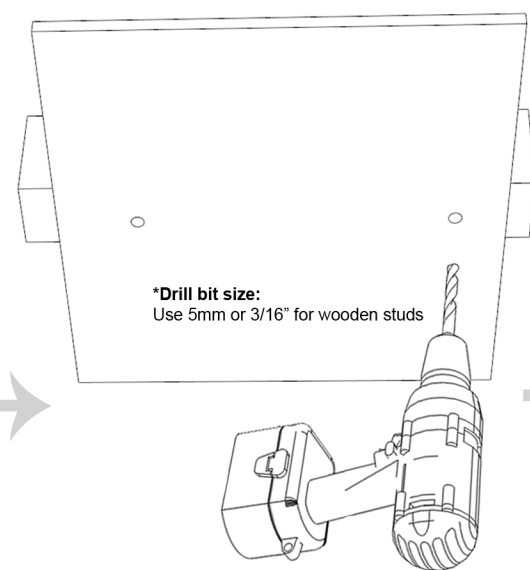

Secure Wall Plate

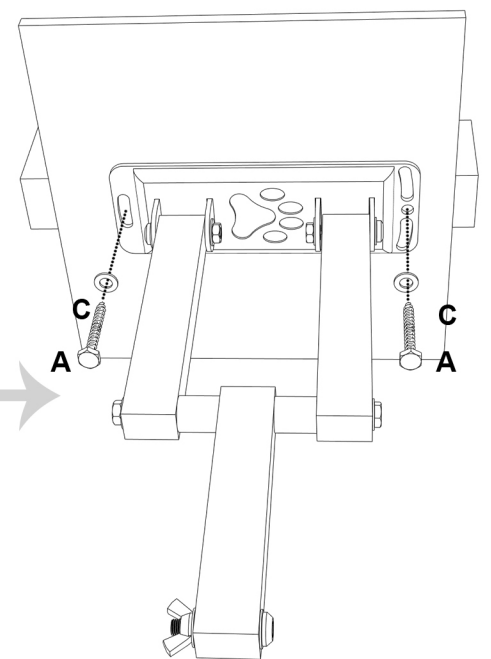

TV Plate Installation:
Option A

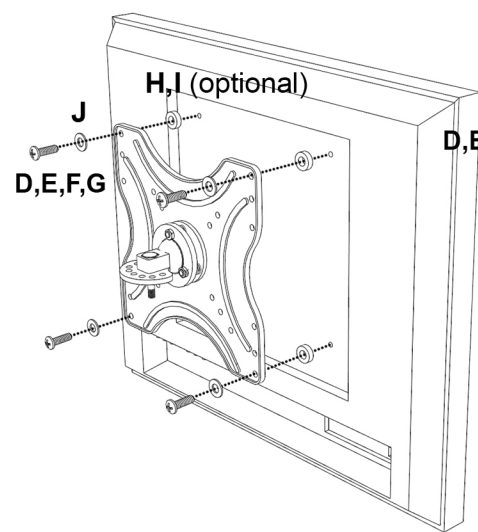

Option B

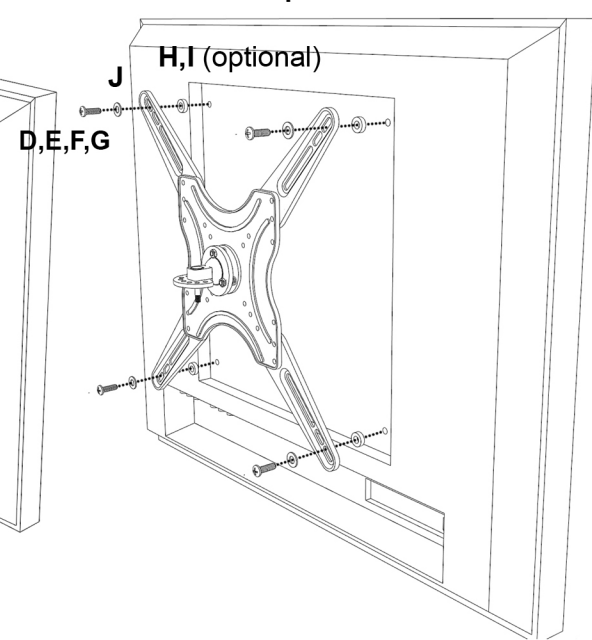

Lift and Lock Mounting

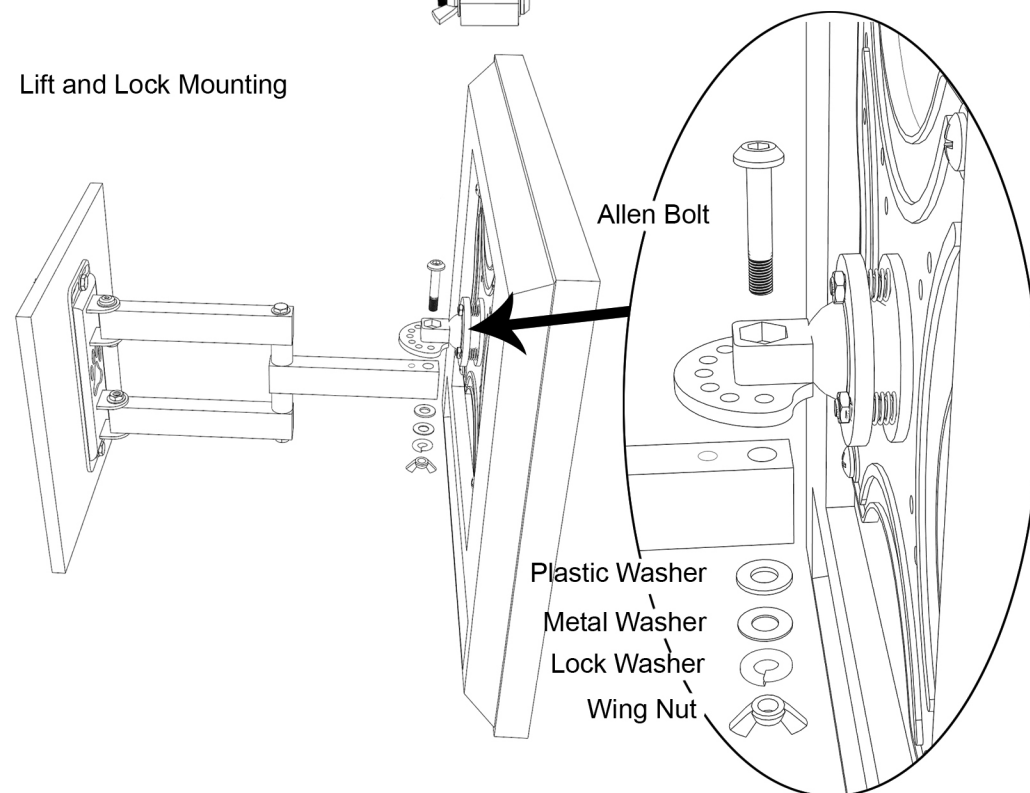

Use screw to lock in position: optional



Adjust Ball tension: optional

